

Door Coupling Details



System 4-45 Hi+

CASEMENT WINDOW

The fabricator must ensure that the window/door design and coupling mullion details can adequately accommodate the anticipated expansion and contraction required for the applicable configuration. For advice please contact Metal Technology's Technical Department.

For advice on horizontal coupling, refer to Metal Technology's Technical Department.

Outer frames to be screw fixed to coupling mullion as indicated on "Coupling Mullion Prep Details" sheets in System 5-35D manual.

All fixings must be sealed using HR50328A or alternative suitable sealant.

EXTERNALLY BEADED MULLION COUPLING TO OPEN IN SYSTEM 5-35D Hi+ DOOR

Mullion

906-206 * 7320 screw length 'L' = 55mm

906-207 * 7320 screw length 'L' = 55mm

907-206 * 7320 screw length 'L' = 55mm

907-207 * 7320 screw length 'L' = 55mm

913-213 * 7201 screw length 'L' = 38mm

943-201 * 7257 screw length 'L' = 32mm

*No 10 x 'L' mm pan head stainless steel self tapping screws

INSIDE

Z section coupling adaptor 996

No 8 x 16mm pan head self drill screw 7305

Cavity thermal foam PH6749/42.5

2 No PH6749/10 thermal foams

Door sash 965-966

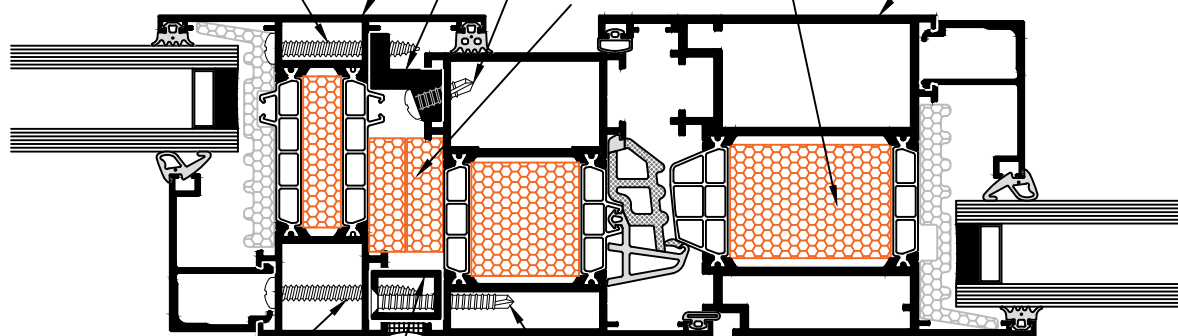

*No 10 x 'L' mm pan head stainless steel self tapping screws

Box section coupling adaptor 995

No 8 x 38mm countersunk self drill screw 7340

Outer frame 902-905

EXTERNALLY BEADED MULLION COUPLING TO OPEN OUT SYSTEM 5-35D Hi+ DOOR

Z section coupling adaptor 996

*No 10 x 'L' mm pan head stainless steel self tapping screws

Mullion

No 8 x 16mm pan head self drill screw 7305

2 No PH6749/10 thermal foams

Centre seal gasket 6061A

Glazing unit perimeter foam PH6743

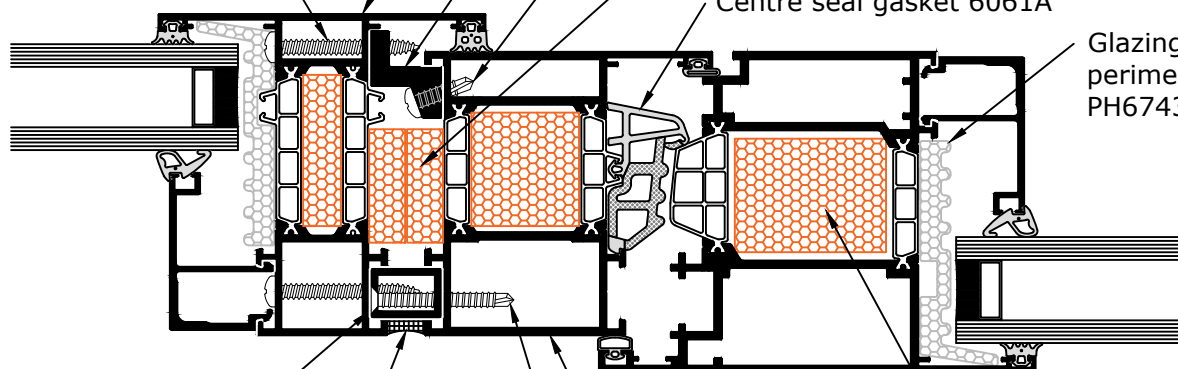

Box section coupling adaptor 995

Sealant

Door sash 967-968

Cavity thermal foam PH6749/39

No 8 x 38mm countersunk self drill screw 7340

OUTSIDE

Scale 1:2